

# Illustrated Index

## 5-Speed

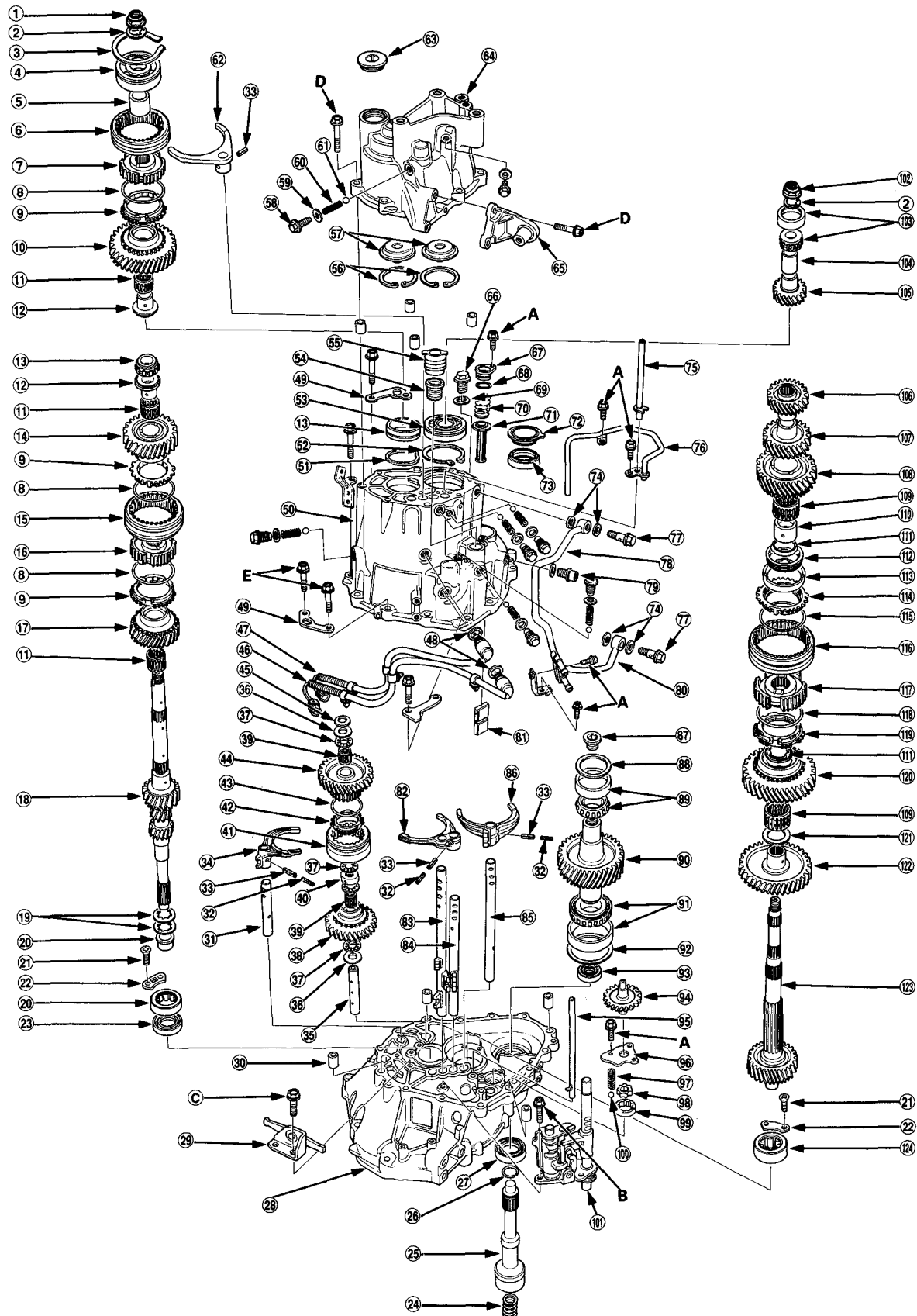



NOTE:

- Always clean the magnet (81) whenever the transmission housing is disassembled.
- Inspect the all ball and needle bearings for wear and operation.

	Torque Value	Bolt Size
A	12 N·m (1.2 kg-m, 9 lb-ft)	6 x 1.0 mm
B	15 N·m (1.5 kg-m, 11 lb-ft)	6 x 1.0 mm
C	26 N·m (2.6 kg-m, 19 lb-ft)	8 x 1.25 mm
D	28 N·m (2.8 kg-m, 21 lb-ft)	8 x 1.25 mm
E	45 N·m (4.5 kg-m, 33 lb-ft)	10 x 1.25 mm

- ① LOCKNUT Replace.  
185 → 0 → 185 N·m  
(18.5 → 0 → 18.5 kg-m,  
134 → 0 → 134 lb-ft)
- ② SPRING WASHER
- ③ SNAP RING
- ④ BALL BEARING
- ⑤ SPACER
- ⑥ 5TH SYNCHRO SLEEVE
- ⑦ 5TH SYNCHRO HUB
- ⑧ SYNCHRO SPRING
- ⑨ SYNCHRO RING
- ⑩ 5TH GEAR
- ⑪ 38 x 44 x 29.5 mm NEEDLE BEARING
- ⑫ 31 x 38 x 34.5 mm DISTANCE COLLAR
- ⑬ NEEDLE BEARING
- ⑭ 4TH GEAR
- ⑮ 3RD/4TH SYNCHRO SLEEVE
- ⑯ 3RD/4TH SYNCHRO HUB
- ⑰ 3RD GEAR
- ⑱ MAINSHAFT
- ⑲ MAINSHAFT WASHERS
- ⑳ 28 x 53 x 19 mm NEEDLE BEARING
- ㉑ FLAT-HEADSCREW Replace.  
10 N·m (1.0 kg-m, 7 lb-ft)
- ㉒ NEEDLE SET PLATE
- ㉓ 28 x 43 x 7 mm OIL SEAL Replace.
- ㉔ SECONDARY SPRING
- ㉕ EXTENSION SHAFT
- ㉖ SET RING Replace.
- ㉗ 55 x 75 x 11 mm OIL SEAL Replace.
- ㉘ CLUTCH HOUSING
- ㉙ REVERSE SHIFT HOLDER
- ㉚ 14 x 20 mm DOWEL PIN
- ㉛ REVERSE SHIFT FORK SHAFT
- ㉜ SPRING PIN 3 x 22 mm Replace.
- ㉝ SPRING PIN 5 X 22 mm Replace.
- ㉞ REVERSE SHIFT FORK
- ㉟ REVERSE GEAR SHAFT
- ㊱ 20 x 36 x 2 mm THRUST WASHER
- ㊲ 20 x 37 x 2.5 mm NEEDLE BEARING
- ㊳ REVERSE DRIVE GEAR
- ㊴ 20 x 25 x 26.5 mm NEEDLE BEARING
- ㊵ SPACER
- ㊶ REVERSE SYNCHRO SLEEVE
- ㊷ SYNCHRO RING
- ㊸ SYNCHRO SPRING
- ㊹ REVERSE SYNCHRO HUB
- ㊺ SPRING WASHER
- ㊻ NEUTRAL POSITION SWITCH
- ㊼ BACK-UP LIGHT SWITCH
- ㊽ WASHERS Replace.
- ㊾ TRANSMISSION HANGER
- ㊿ TRANSMISSION HOUSING
- ① 62 mm SNAP RING
- ② 78 mm SNAP RING
- ③ 32 x 78 x 20 mm BALL BEARING
- ④ 16 x 27 x 16 mm OIL SEAL Replace.
- ⑤ SHIFT ROD BOOT
- ⑥ SNAP RING
- ⑦ OIL GUIDE PLATE
- ⑧ SEALING BOLT
- ⑨ WASHER Replace.
- ⑩ SPRING L. 21.0 mm (0.83 in)
- ⑪ STEEL BALL D. 5/16 in
- ⑫ 5TH SHIFT FORK
- ⑬ 36 mm SEALING BOLT
- ⑭ 25 N·m (2.5 kg-m, 18 lb-ft)
- ⑮ TRANSMISSION COVER
- ⑯ EXTENSION STAY
- ⑰ OIL FILLER PLUG
- ⑱ 45 N·m (4.5 kg-m, 33 lb-ft)
- ⑲ STRAINER COVER
- ⑳ 29.7 x 2.4 mm O-RING Replace.
- ㉑ WASHER Replace.
- ㉒ STRAINER SET SPRING
- ㉓ OIL PUMP STRAINER
- ㉔ SECONDARY COVER
- ㉕ 45 x 61 x 8 mm OIL SEAL Replace.
- ㉖ WASHERS Replace.
- ㉗ OIL GUIDE PIPE
- ㉘ REVERSE PIPE
- ㉙ JOINT BOLT
- ㉚ 29 N·m (2.9 kg-m, 21 lb-ft)
- ㉛ OIL PUMP PIPE B
- ㉜ DRAIN PLUG
- ㉝ 40 N·m (4.0 kg-m, 29 lb-ft)
- ㉞ OIL PUMP PIPE A
- ㉟ MAGNET
- ㊱ 3RD/4TH SHIFT FORK
- ㊲ 5TH/REVERSE SHIFT FORK SHAFT
- ㊳ 3RD/4TH SHIFT FORK SHAFT
- ㊴ 1ST/2ND SHIFT FORK SHAFT
- ㊵ 1ST/2ND SHIFT FORK
- ㊶ 36 mm SEALING BOLT
- ㊷ 80 N·m (8.0 kg-m, 58 lb-ft)
- ㊸ 75 mm THRUST SHIM  
Selection, page 13-48
- ㊹ TAPERED ROLLER BEARING
- ㊺ SECONDARY GEAR
- ㊻ TAPERED ROLLER BEARING
- ㊼ 90 mm THRUST WASHER
- ㊽ 37.5 x 47 x 7 mm OIL SEAL Replace.
- ㊾ OIL PUMP SHAFT
- ㊿ OIL GUIDE PIPE C
- ① OIL PUMP PLATE
- ② RELIEF VALVE SPRING  
L. 16.84 mm (0.663 in)
- ③ OIL PUMP INNER ROTOR
- ④ OIL PUMP OUTER ROTOR
- ⑤ STEEL BALL D. 5/16 in
- ⑥ CHANGE HOLDER
- ⑦ LOCKNUT Left-hand threads  
Replace.  
165 → 0 → 165 N·m  
(16.5 → 0 → 16.5 kg-m,  
120 → 0 → 120 lb-ft)
- ⑧ 28 x 62 x 16 mm NEEDLE BEARING
- ⑨ SPACER
- ⑩ 5TH GEAR
- ⑪ 4TH GEAR
- ⑫ 3RD GEAR
- ⑬ 2ND GEAR
- ⑭ 47 x 53 x 31 mm NEEDLE BEARING
- ⑮ SPACER  
Selection, page 13-43
- ⑯ FRICTION DAMPER
- ⑰ INNER SYNCHRO RING
- ⑱ SYNCHRO CONE
- ⑲ OUTER SYNCHRO RING
- ⑳ SYNCHRO SPRING
- ㉑ 1ST/2ND SYNCHRO SLEEVE
- ㉒ 1ST/2ND SYNCHRO HUB
- ㉓ SYNCHRO SPRING
- ㉔ SYNCHRO RING
- ㉕ LOW GEAR
- ㉖ 60 mm THRUST SHIM  
Selection, page 13-43
- ㉗ REVERSE GEAR
- ㉘ COUNTERSHAFT
- ㉙ 33 x 62 x 22 mm NEEDLE BEARING